

TANDEM – The versatile runner system



www.blum.com

 **blum**

Quality steel for your wooden design ideas

TANDEM is a concealed runner system and the versatile solution to your wooden ideas. The extremely wide range of options offers great design flexibility. Choose from a broad selection of nominal lengths, various types of extension and load bearing classes as well as optional motion technologies for soft and effortless opening and closing. No matter which TANDEM version you opt for, you will provide your customers with stability and a feather-light glide that lasts for the life of the furniture.

Contents

TANDEM

- 04 Application options
- 08 Product properties
- 14 Services and assembly devices
- 16 Blum runner systems

Ordering and planning information

- 18 560H locking device feature – full extension
- 21 550H locking device feature – single extension
- 23 Accessories
- 23 Attachment of runners





TANDEM in action

A particular advantage of TANDEM is the broad product range. The concealed runner system is available as a full or single extension. What is more, it comes in a wide range of nominal lengths, ranging from 250 to 550 mm. This makes the runner system perfect for the widest variety of applications, from a flat and deep pull-out for clothing in the bedroom or an odds and ends drawer in the hall, to a narrow yet deep pull-out for personal care products in the bathroom.



Runner systems | TANDEM

blum



TANDEM in the bathroom

Bathroom furniture needs to be well thought out. With the TANDEM range, you can even implement wide drawers with short nominal lengths thanks to our optional side stabiliser. Especially important in the bathroom: the zinc plated runners and nylon roller carriages offer the best protection against corrosion.







TANDEM Properties



TANDEM feather-light glide – smooth running action for the lifetime of the furniture

A quiet, feather-light glide is what sets TANDEM apart. Low-friction cylindrical nylon rollers ensure that the weight of the drawer is well-distributed and no metal wear can occur. Thanks to Blum motion technologies, drawers open and close softly and effortlessly.



TANDEM offers more storage space and impressive stability

TANDEM has a load bearing capacity of 30 kg. Thanks to good sag values, it is also suitable for pull-outs that are near the floor as well as extra wide, high and deep pull-outs – even when the drawers are fully laden.



Different types of extension – the right model for every application

To give you greater design flexibility, TANDEM comes with different types of extension. The full extension is the right choice if you want particularly easy access without any loss of storage space. And TANDEM single extension is ideal for smaller items of furniture, such as a bedside table.

Motion technologies for TANDEM

TANDEM can be combined with different motion technologies. Adaptive soft-close BLUMOTION ensures soft and effortless closing, while the SERVO-DRIVE electrical opening support system makes opening particularly easy. A single touch suffices and the drawer seems to open by itself.

BLUMOTION

by Blum

SERVO-DRIVE

by Blum







Assembly with locking device

Locking device feature – insert and all done!

With the TANDEM locking device, you can attach and remove the drawer in no time. An integrated lift-off stop prevents accidental detachment. Height adjustment allows differences of up to 3 mm to be balanced out. The front can be aligned parallel to the cabinet front edge using the tilt adjustment feature.

Services and assembly devices – precise, practical and professional

We offer bespoke services and assembly devices for the TANDEM runner system. We support you along the entire process chain: our E-SERVICES help you to plan, design and choose products around the clock. In addition to drilling and insertion machines, we also offer special drilling templates for furniture production, such as for the TANDEM front adjuster.



Product Configurator
www.blum.com/productconfigurator

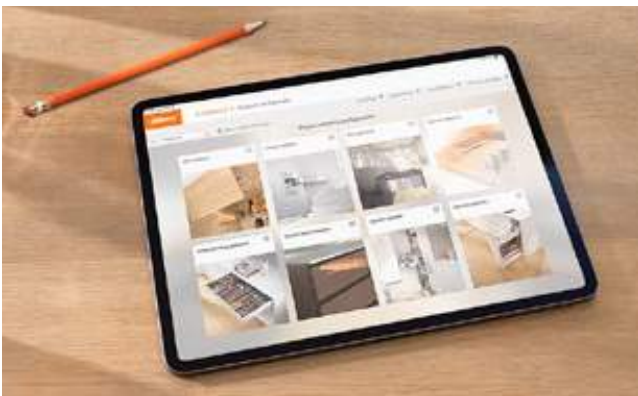

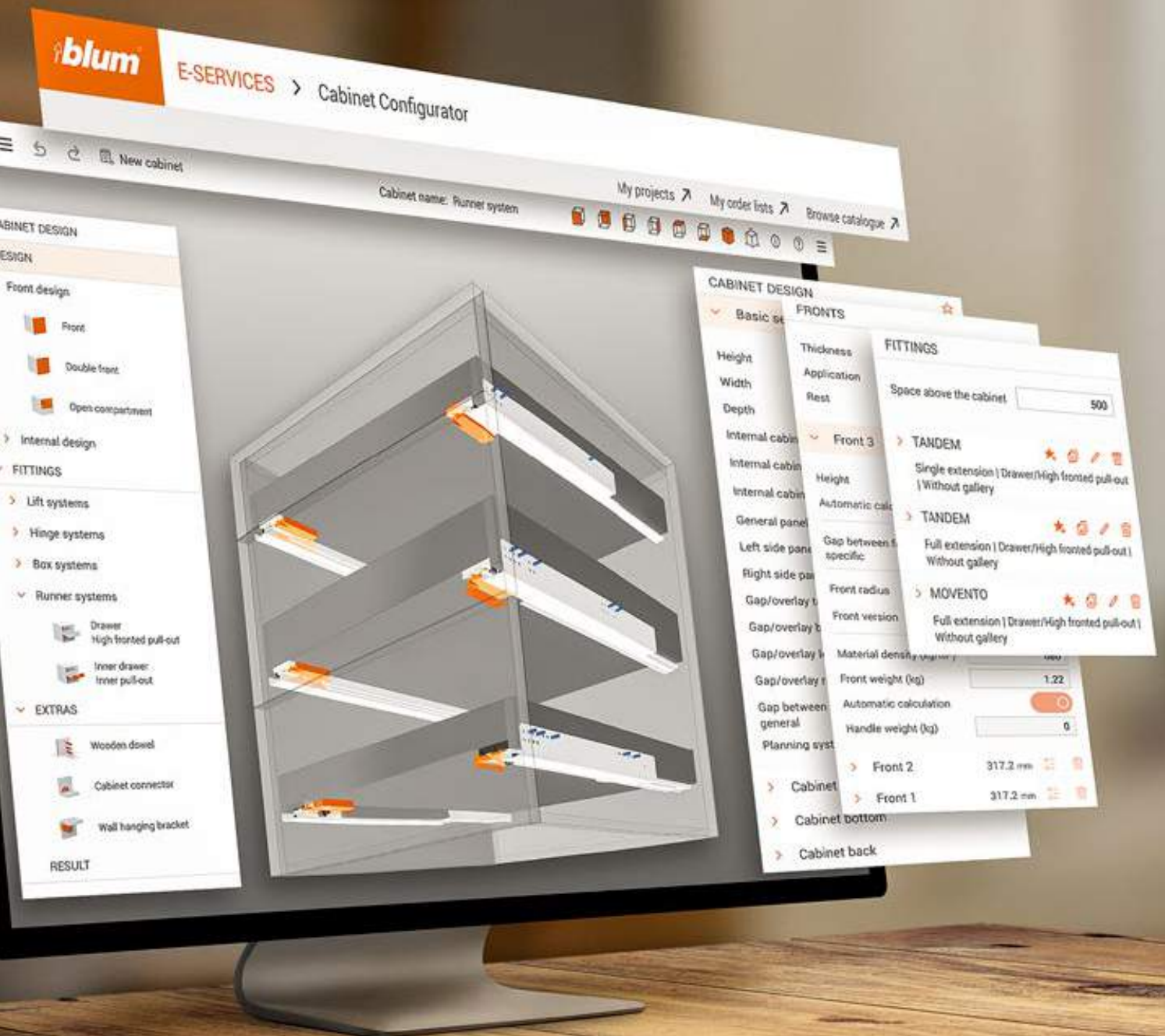

Cabinet Configurator
www.blum.com/cabinetconfig

The right runner system for every requirement

Depending on your requirements, there are several different runner systems for your drawers. The versatile TANDEM runner system impresses with a broad range: choose from two types of extension and two motion technologies. The MOVENTO concealed runner system is the sophisticated solution to meet exacting requirements: it boasts a synchronised feather-light glide, 4-dimensional adjustment and is fully compatible with three Blum motion technologies.

TANDEM Full extension

TANDEM Single extension

MOVENTO



560H locking device feature – full extension – BLUMOTION



- Concealed runner system for wooden drawers with a panel thickness of 11 to 16 mm
- TANDEM full extension with integrated BLUMOTION motion technology for soft and effortless closing
- Compatible with the SERVO-DRIVE electrical opening support system
- Low-friction cylindrical nylon rollers ensure a feather-light glide
- Tool-free height adjustment via a locking device
- Tool-free integrated front tilt adjustment
- Built-in width and depth tolerance compensation

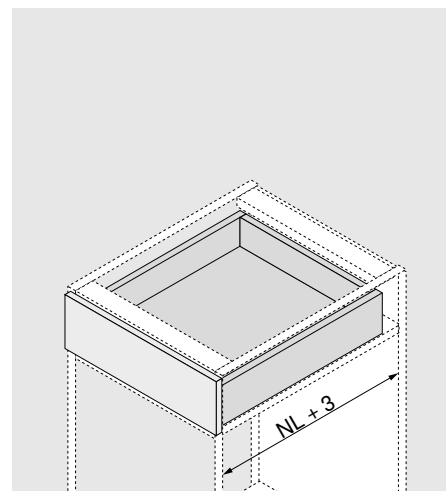

Ordering information

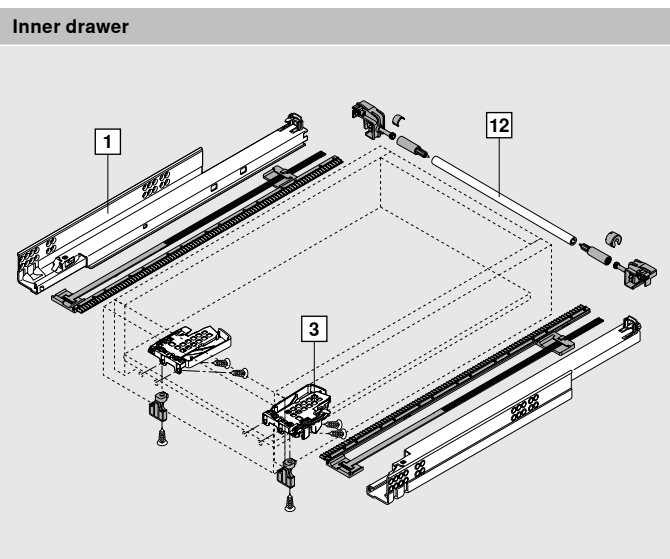
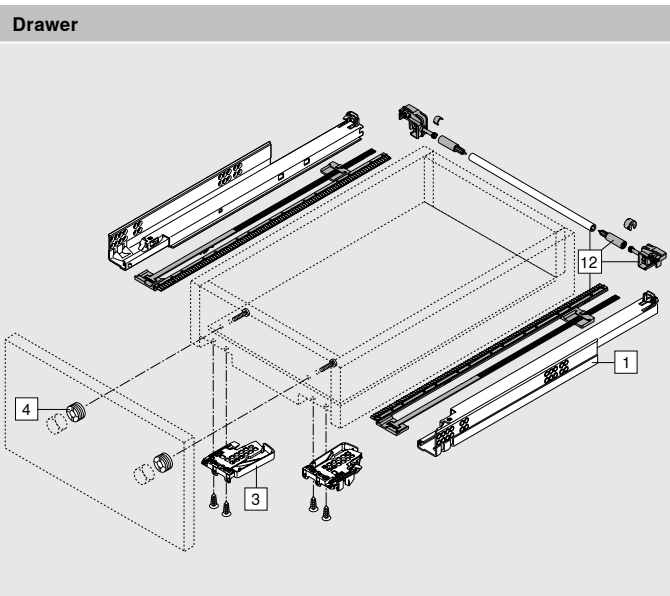

1	Runners left/right	
	Nominal length NL	Load bearing capacity 30 kg
	mm	
	250	560H2500B
	270	560H2700B
	300	560H3000B
	350	560H3500B
	400	560H4000B
	450	560H4500B
	500	560H5000B
	550	560H5500B
Integrated BLUMOTION		

3	Locking device left/right	
	Nylon/zinc	T51.1700.04
	Orange	
	Order left and right	



560H locking device feature – full extension – BLUMOTION

Accessories

4	Front adjuster	
	Nylon Natural	
		295.1000
12	Side stabilisation set for full extension	
	Nominal length NL mm	
	Up to 410	ZST.410TV
	Up to 600	ZST.600TV
	For cutting to size Suitable for cabinet width up to KB 1400 mm	
	Cutting dimensions: Internal cabinet width LW - 254 mm Nominal length NL + 12 mm	

560H locking device feature – full extension – BLUMOTION

Planning

Space requirements in the cabinet	Drawer/inner drawer	Drawer	Inner drawer
<p>* +3 mm with side stabilisation</p>	<p>SKW Internal drawer width</p> <p>LW Internal cabinet width</p>	<p>SKL Drawer length</p> <p>NL Nominal length</p> <p>* Additional +12 mm with side stabilisation</p>	<p>ISKL Inner drawer length</p> <p>SKL Drawer length</p> <p>NL Nominal length</p> <p>X Front thickness</p>

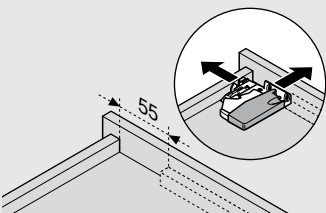
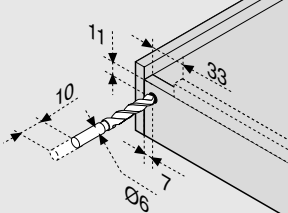
Drawer assembly	
 <p>Diagram illustrating the first step of drawer assembly. A circular inset shows a close-up of the locking device being installed into the cabinet side rail. Dimension 55 is indicated.</p>	 <p>Diagram illustrating the second step of drawer assembly. A close-up of the locking device being secured with a screw. Dimensions 11, 10, 33, 7, and Ø6 are indicated.</p>
Use drilling template T65.1000.02	Use drilling template T65.1000.02

550H locking device feature – single extension – BLUMOTION



- Concealed runner system for wooden drawers with a panel thickness of 11 to 16 mm
- TANDEM single extension with soft end stop when opening and integrated BLUMOTION motion technology for soft and effortless closing
- Compatible with the SERVO-DRIVE electrical opening support system
- Low-friction cylindrical nylon rollers ensure a feather-light glide
- Tool-free height adjustment via locking device
- Built-in width and depth tolerance compensation

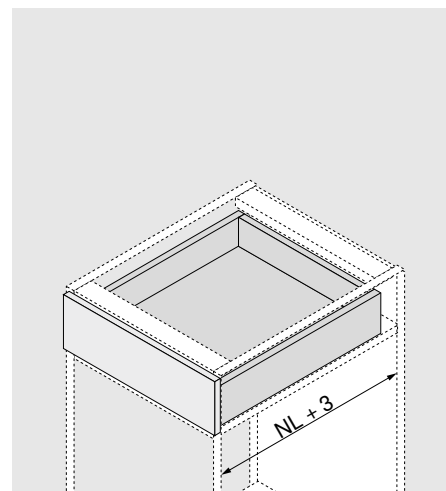

Ordering information

1	Runners left/right	
	Nominal length NL mm	Load bearing capacity 30 kg
	270	550H2700B
	300	550H3000B
	350	550H3500B
	400	550H4000B
	450	550H4500B
	500	550H5000B
	550	550H5500B
Integrated BLUMOTION		

3	Locking device left/right	
	Nylon/zinc Orange	T51.1700.04
	With height adjustment	
	Order left and right	

Accessories

4	Front adjuster	
	Nylon Natural	295.1000

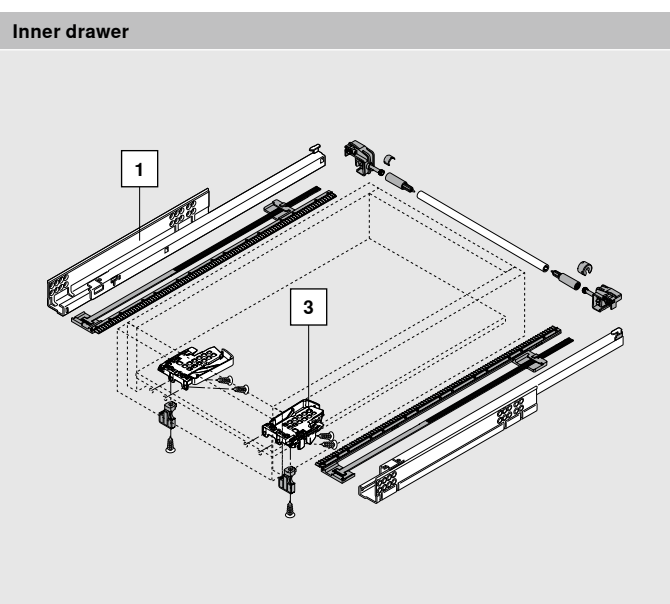
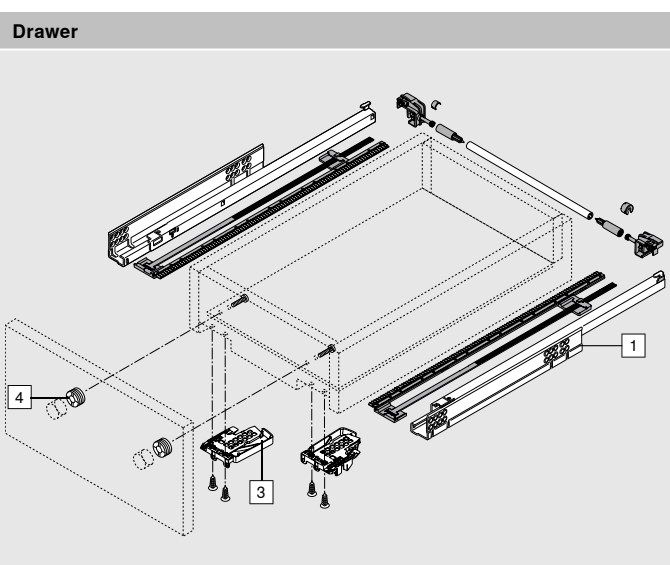

550H locking device feature – single extension – BLUMOTION

Planning

Space requirements in the cabinet	Drawer/inner drawer	Drawer	Inner drawer
<p>A 3 mm distance for exchange with full extension</p>	<p>SKW Internal drawer width</p> <p>LW Internal cabinet width</p>	<p>SKL Drawer length</p> <p>NL Nominal length</p>	<p>ISKL Inner drawer length</p> <p>SKL Drawer length</p> <p>NL Nominal length</p> <p>X Front thickness</p>

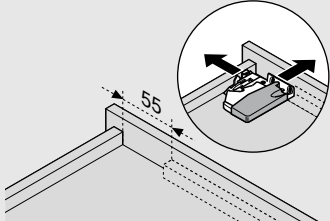
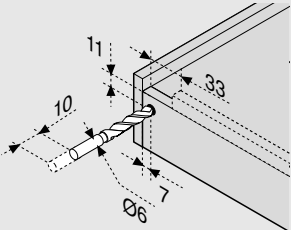
Drawer assembly	
	

Use drilling template T65.1000.02

Use drilling template T65.1000.02



Assembly, adjustment and removal
www.blum.com/a_tandem

Accessories

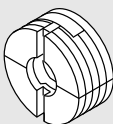

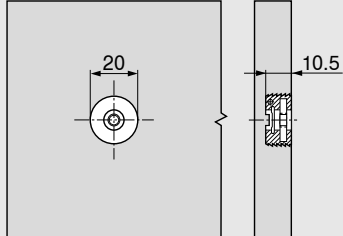
Front adjuster	
	With pre-mounted steel flange For four sided drawers 2-dimensional front adjustment (± 2 mm) Material: nylon Colour: natural
	295.1000

Planning

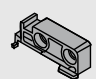
Insertion ram for MINIPRESS + PRO-CENTER MZM.0095

Side stabilisation set for full extension	
	Nominal length NL mm
	Up to 410 ZST.410TV
	Up to 600 ZST.600TV
	For cutting to size Suitable for cabinet width up to KB 1400 mm Cutting dimensions: Internal cabinet width LW - 254 mm Nominal length NL + 12 mm

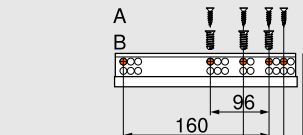
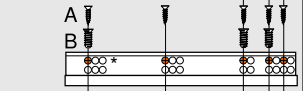
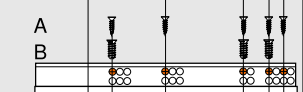
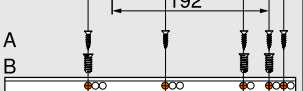
Back fixing bracket	
	Nylon Natural
	T51.7000.01

Attachment of runners 560H

Runner 560H – 30 kg	
NL 250–270	
NL 300–350	
NL 400	
NL 450	
NL 500–550	
NL	Nominal length
A	Chipboard screw $\varnothing 4 \times 15$ mm
B	System screw, part number 661.1450.HG
*	BLUMOTION

Attachment of runners 550H

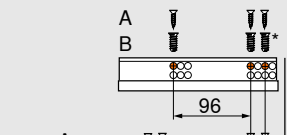
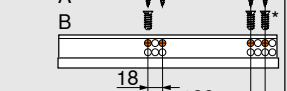
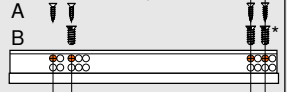
Runner 550H – 30 kg	
NL 270	
NL 300–450	
NL 500–550	
NL	Nominal length
A	Chipboard screw $\varnothing 4 \times 15$ mm
B	System screw, part number 661.1450.HG
*	Can be replaced with chipboard screw $\varnothing 4 \times 15$ mm

Blum Canada Ltd.
6775 Maritz Drive
Mississauga, ON, L5W 0H5
Tel.: 905-670-7920
Long Dist.: 1-800-670-9254
E-Mail: info.ca@blum.com

Julius Blum GmbH
Furniture Fittings Mfg.
6973 Höchst, Austria
Tel.: +43 5578 705-0
Fax: +43 5578 705-44
E-mail: info@blum.com
www.blum.com

Our sites in Austria, Poland and China are certified to the international standards mentioned below.
Our site in the USA is certified to ISO 9001.
Our site in Brazil is certified to ISO 9001, ISO 14001 and ISO 45001.



ISO 9001
Certified Quality
System



ISO 14001
Certified Environmental
System



ISO 50001
Certified Energy
System

 **blum**®



Look for our
FSC®-certified
products

All content is copyrighted by Blum.
Subject to technical modifications and changes to the range without notice.
IDNR: 165.633.7 · EP-611/1 EN-CA/03.23